

ROTARY EVAPORATORS EVAPORATION SOLUTIONS



LabTech

Zetalab.it
Distribuito da: **Zetalab s.r.l.**

Via Umberto Giordano, 5 - 35132 Padova
Tel 049 2021144 - Fax 049 2021143
www.zetalab.it - email: info@zetalab.it

EVAPORATION SOLUTIONS

The LabTech evaporation solutions introduce a new concept in routine distillation/evaporation processes: safety, efficiency and durability to support the lab user work!

With an innovative and ergonomic design, the EV series rotary evaporators include color digital display to monitor and control rotation speed and temperature, motorized vertical lift, evaporation flasks, on line sample adding through PTFE valve and can be completed with the LabTech vacuum and cooling accessories to reach top efficiency of process.

The stand alone heating bath guarantees maximum safety in operations and easy maintenance.



- Total solution
- Programmable operations
- Anticorrosion sealing system
- Integrated vacuum control
- Maximum safety
- Quite operation
- Excellent price/performance ratio

MAIN APPLICATIONS

- Solvent recycling
- Solvent distillation
- Powder drying
- Chemical synthesis
- Extraction
- Research
- Active agent concentration
- Vacuum distillation of sensitive substances
- Liquid mixture separation

THE IDEAL PARTNER FOR LABORATORY EVAPORATIONS



Technology & Design

- Digital rotation speed control and temperature display ensure accurate and stable unit operations.
- Trouble free operation and long lifetime
- PTFE seal loop ensures excellent elasticity and resistance at high temperature acid/solvent corrosion.
- Online sample addition by PTFE valve ensures high efficiency and easy operation.
- Automatic lift-up protection in case of electric power failure.
- Pre-loaded solvents library.

Safety & Easy to use

- Stand alone heating bath guarantees maximum safety and easy maintenance.
- Motorized vertical lift (depending on model).
- Wide range of evaporation flasks.
- Self calibration function and wide temperature range control from room temperature up to 230°C.
- Automatic stop heating in dry bath condition
- Innovative design to prevent corrosion and splashing.
- Removable front panel.

TECHNICAL SPECIFICATIONS

	EV400H	EV400	EV400 Touch	EV400VAC
▪ MAIN UNIT				
Rotation speed range (rpm)	20-300	20-300	20-300	20-300
Display	LCD	LCD	Color Touch	Color Touch
Lift	Manual	Motor	Motor	Motor
Lift stroke (mm)	150	160	160	160
Head tilt angle (°)	0-60	0-60	0-60	0-60
Condenser	Vertical <i>or</i> Diagonal	Vertical <i>or</i> Diagonal	Vertical <i>or</i> Diagonal	Vertical <i>or</i> Diagonal
Cooling surface (cm ²)	1200 standard 1500 optional	1200 standard 1500 optional	1200 standard 1500 optional	1200 standard 1500 optional
Clockwise counter/rotation	Yes	-	Yes	Yes
Gradient distillation	-	-	-	Yes
Built-in vacuum controller	-	-	-	Yes
Solvents library	-	-	-	Yes
Vapor temperature	-	-	Optional	Optional
Auto distillation	-	-	-	Optional
▪ HEATING BATH				
Temperature range (°C)	Ambient-230	Ambient-230	Ambient-230	Ambient-230
Temperature controller mode	P.I.D.	P.I.D.	P.I.D.	P.I.D.
Bath material	SS with PTFE coating	SS with PTFE coating	SS with PTFE coating	SS with PTFE coating
Temp. control accuracy (°C)	±1 (Water) ±2 (Oil)	±1 (Water) ±2 (Oil)	±1 (Water) ±2 (Oil)	±1 (Water) ±2 (Oil)
Heating power (W)	1300	1300	1300	1300
Bath capacity (L)	5	5	5	5
▪ GENERAL				
Protection class	IP21	IP21	IP21	IP21
Dimensions* (LxWxH cm)	38x56x90	44x56x90	44x56x90	44x56x90
Gross weight* (Kg)	23	29	29	29
Power supply voltage	230V, 50/60Hz 110V, 60Hz	230V, 50/60Hz 110V, 60Hz	230V, 50/60Hz 110V, 60Hz	230V, 50/60Hz 110V, 60Hz
Ordering information	LEV400H	LEV400	LEV400T	LEV400V

* Including glassware

ROTARY EVAPORATOR ACCESSORIES

Item	Part number	Description
1	50103-V	Vertical Condenser
1	50103-L	Diagonal Condenser
1	50103-I	Dry Ice Condenser
1	50104 T-V	Vertical Condenser Vapour Sensor Hole
1	50104 T-L	Diagonal Condenser Vapour Sensor Hole
2	50103-NC	Hose Nipple
3	50103-A	Stop Cock
4	50103-CS	Ball Joint Clamp
5	50103-SR3	Lock Handwheel

Item	Part number	Description
6	50103-SR9	Lock Spring
7	50103-SR1	Seal Ring Set
8	50103-NS	Lock and Push-off nuts Set
9	50103-GA	Vapor Tube
10	50103-C1	Clip 19 mm
10	50103-C2	Clip 24 mm
10	50103-C3	Clip 29 mm
11	50103-1000	Evaporating Flask 1L
12	50103-C1	Receiving Flask 1L

EVAPORATION FLASK

P/N	Volume	Joint Size
50103-0050	50 mL	29/32
50103-0100	100 mL	29/32
50103-0250	250 mL	29/32
50103-0500	500 mL	29/32
50103-1000	1000 mL	29/32
50103-2000	2000 mL	29/32
50103-3000	3000 mL	29/32
50103-0100	100 mL	24/29
50103-0250	250 mL	24/29

HEART-SHAPED FLASK

P/N	Volume	Joint Size
50102-0050J	50 mL	24/29
50102-0100J	100 mL	24/29
50101-0050J	50 mL	19/16

ADAPTOR

P/N	Volume	Joint Size
50103-29-24	29/32	24/29
50103-29-19	29/32	19/26
50103-24-19	24/29	19/26

RECEIVING FLASK

P/N	Volume	Joint Size
50103-C0	500 mL	35/20
50103-C1	1000 mL	35/20
50103-C2	2000 mL	35/20

TRAP BALL

P/N	Volume	Joint Size
50103-0001	100 mL	29/32 24/29

SPIDER WITH 5 FLASKS

P/N	Volume	Joint Size
50104-29-24	50 mL 5 pcs	29/32 24/29

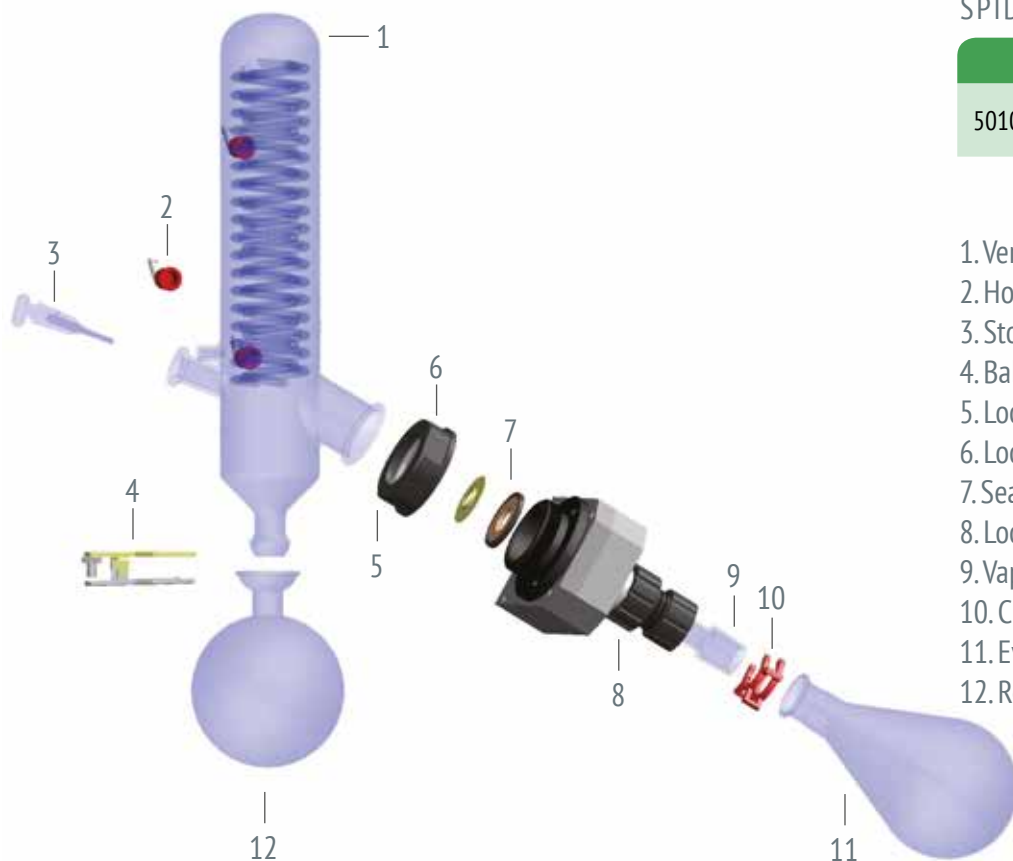

1. Vertical/Diagonal/ Dry Ice Condenser
2. Hose Nipple
3. Stop Cock
4. Ball Joint Clamp
5. Lock Handwheel
6. Lock Spring
7. Seal Ring Set
8. Lock and Push-off Nuts Set
9. Vapor Tube Set
10. Clip 19/24/29 mm
11. Evaporating Flask 1L
12. Receiving Flask

LabTech

WWW.LABTECHSRL.COM

LabTech, your reliable laboratory solution provider.

LabTech is a leading manufacturing company with skill and passion devoted to provide advanced laboratory solutions to the analytical community. We are located in Sorisole, northern Italy, with facilities in USA and China. Incorporated with global branches, LabTech is organized into R&D, production, marketing & sales and customer support. Major LabTech products include organic/inorganic sample preparation systems, laboratory cooling/heating/temperature control equipments, analytical instruments and gas generators. With knowledgeable scientists and experienced engineers, our R&D team has developed and released a series of new lab equipments and instruments dedicated to the modern analytical laboratories. With all of these accomplishments and our endless research and development efforts, we are proud to be your professional partner.



Distribuito da:
Zetalab s.r.l.

Via Umberto Giordano, 5 - 35132 Padova
Tel 049 2021144 - Fax 049 2021143
www.zetalab.it - email: info@zetalab.it

Zetalab.it