

CO Transmitter GT1-CO



- TÜV certification according to VDI 2053
- Long-lasting electrochemical measuring cell
- Automatic zero calibration

Characteristics

The GT1-CO is a high-quality and TÜV certified CO transmitter (incl. measuring cell) for detection of carbon monoxide in underground and parking garages, boiler plants, heating systems, garages as well as in ambient air.

The GT1-CO has a very long-lasting electrochemical measuring cell. It can be easily integrated in existing CO surveillance systems (without loss of validity of existing TÜV certificates).

Displays, controller and alarm devices can be connected via 2-wire system without difficulty.

Technical data

| | |
|-------------------------------|--|
| Measuring range | : 0..300 ppm CO (carbon monoxide) |
| Measuring principle | : electrochemical, permanent measuring |
| Reproducibility | : < 3 ppm according to VDI 2053 |
| Response time T ₉₀ | : < 60 s |
| Cross sensitivity | : ≤ 2 % of 300 ppm CO |
| Linearity error | : ≤ 2 % of 300 ppm CO |
| Offset adjustment | : automatic |
| Output signal | : 4..20 mA, 2-wire |
| Working temperature | : -10..+40 °C |
| Power supply | : 12..28 V DC (at option VO: 16..26 V DC) |
| Permissible burden | : R _A [Ω] = (U _V [V] - 12 V or 16 V) / 0.02 A |
| Electric connection | : elbow-type plug (EN 175301-803/A), max. wire cross section: 1.5 mm ² , wire diameter from 4.5..7.0 mm |
| Housing | : ABS |

Dimensions

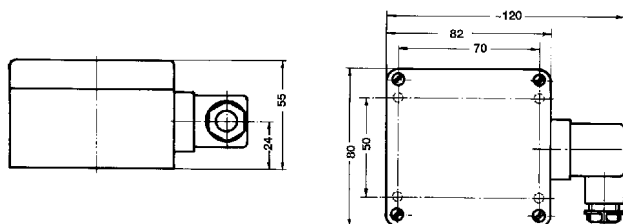

Ordering code

GT1-CO - 1.

| 1. Option | |
|-----------|-----------------|
| 00 | without option |
| VO | on-site display |

Ordering example:
GT1-CO-00

Accessories

GZ-01

Test gas cap GT (for controlled flow with test gas)

GZ-02

Gas bottle with 12l test gas: 30 ppm CO

GZ-03

Gas bottle with 12l test gas: 300 ppm CO

GZ-04

Gas valve unit MiniFlo for 12l gas bottles